

PSL
FIRE & SAFETY
TRUSTED SINCE 1913



PRODUCT
CATALOGUE

Rev: June 2023

PSL
FIRE & SAFETY
TRUSTED SINCE 1913



Welcome to PSL Fire & Safety

Phillips & Smith Limited (PSL) is 100% New Zealand owned and operated since 1913.

At PSL, our expertise comes from a huge pool of knowledge of the Fire and Safety industry, both from our talented staff and the extensive list of internationally recognised suppliers we have relationships with.

Your Safety is Our Business underlines our passion toward quality and excellence in such a life-critical industry, bringing products, service and knowledge to our customers and numerous fire and safety organisations we work with.

Look for the PSL Stamp for customised products designed and manufactured by our engineers. A majority of these products can be modified to suit your requirements including materials and finishes.

Please note that this catalogue is current at date of print however PSL Fire & Safety reserve the right to add or delete products or services without notification.

If you can't find what you're looking for please contact us directly and we'll do our best to accommodate your needs!

Sales Team - sales@pslfireandsafety.co.nz

Or contact one of our Business Development Managers...

Auckland / Upper North Island - Alistair Ramsey - +64 21 615 417

Lower North / South Island - Murray Lamb - +64 27 722 2265

Suppression Systems Manager - Steve Smith - +64 21 613 131

International / Pacific - Mark Van Dorsten - +64 21 762 181

TABLE OF CONTENTS

1. ADAPTORS/FITTINGS/FIRE HARDWARE	
INSTANTANEOUS ADAPTORS	4
SINGLE LEVER ADAPTORS.....	5
ROUND THREAD ADAPTORS	6
BLANK CAPS	7
FLOW METERS.....	8
INLET MANIFOLDS & COLLECTING HEADS.....	9
LADDERS, GANTRIES & SHUTTERS.....	10
RISER MAIN LANDING VALVES.....	11
STANDPIPES.....	12
2. FIRE EXTINGUISHERS – DRY POWDER.....	13
CO ₂ , WATER, FOAM & WET CHEMICAL.....	14
FIRE BLAZONS.....	15
FIRE BLANKETS.....	16
3. FOAM & FOAM EQUIPMENT.....	17
4. FORESTRY FIRE EQUIPMENT	20
5. FORESTRY ADAPTORS.....	21
6. FORESTRY BREECHINGS.....	22
7. GENERATORS & VENTILATORS.....	23
8. HOSE & COUPLINGS.....	23
9. SUCTION HOSE.....	24
10. COUPLINGS.....	25
11. HOSE CABINETS / HOSE REELS.....	26
12. MONITORS / HOSE REEL NOSSLES.....	27
13. NOZZLES	28
14. PERSONAL PROTECTION	29
15. FOOT WEAR	30
16. PROTECTIVE CASES	31
17. PUMPS	33
18. THERMAL IMAGING / RESCUE TOOLS.....	34
19. RESCUE EQUIPMENT.....	35
20. SIRENS / SMOKE ALARMS & HEAT ALARMS.....	36
21. SPECIAL MANUFACTURER.....	37
22. STREAMLIGHTTORCHES.....	38
SMALL / MEDIUM TORCHES.....	38
LARGE TORCHES & LANTERNS.....	39
INTRINSICALLY SAFE TORCHES.....	40
HEADLAMPS.....	41

Fire Suppression Systems NZ

The primary purpose of any fire equipment is to save lives, secondary is to save property. That said often the two purposes can be interlinked, but simply if you reduce the risk to one you reduce the risk to the other.

Normally a fire suppression system is installed to target a risk that has been identified as potentially damaging to people or property & in some cases it could be a piece of irreplaceable & often crucial machinery.

Sometimes there can be other reasons for installing the fire suppression systems such as a requirement that they be installed to operate in certain forests, underground mining, landfills, tunnels, flammable environments & materials or for regulatory reasons.



As a New Zealand owned company we take great pride in being able to help to protect people & property by helping to create & maintain safe environments for those working in our industrial sector. An integral part of this is the fire suppression division which can offer our clients support by ensuring that these fire suppression systems remain fully functional through the whole of their operational life.

Developing Fire-Fighting solutions that can cater for specific risks or meet particular requirements is our speciality. The potential benefits of saving people, plant, machinery & property are significant as is the ability to avoid or at least minimize disruption to your businesses.

Forestry – Whether you need a system for a work ute or a harvesting machine PSL Fire and Safety offers fire suppression systems that are ideally suited to the demands & requirements of New Zealand's forestry environment.

Mining – PSL Fire and Safety offer a range of intrinsically safe fire suppression systems that are widely used in mining operations & can be tailored to suit the needs of most clients.

Construction – whether you are protecting fixed or mobile plant PSL Fire and Safety can cater for your fire suppression system requirements.

Landfills – Landfills have decomposing materials releasing flammable gases such as methane, materials lodging both in as well as on vehicles machinery & all manner of products on site an intrinsically safe & effective fire suppression system that can operate 24hours 7 days a week is a must. It can help to protect people, plant, machinery & property from the potential damage & disruption a fire can cause, especially as a fires can & have broken out after hours due to material trapped on a machine smouldering before igniting after the machine is parked up.

Marine – when at sea a fire can be devastating as unless your on-board safety systems including your Fire-Fighting systems are up to task you can be left vulnerable to the effects of a uncontrolled fire. It is vitally important that your fire suppression systems are not only provided but also maintained.

Heavy Transport – with heavy transport operations often there is an inherent risk of fire which can be associated with these activities. Heavy transport vehicles can often be operating for long periods of time, with a variety of different materials, sometimes in adverse conditions & be subject to a variety of stresses. These conditions can increase the risk of fire affecting both yourself & others, so taking pro-active steps to reduce your vulnerability to fire can be a sensible & beneficial approach.

For more information please go to our website <https://www.pslfireandsafety.co.nz/pages/fire-suppression-systems> or contact Suppression Systems Manager - Steve Smith on +64 21 613 131

ADAPTORS / FITTINGS / FIRE HARDWARE



Instantaneous Adaptors

Light Alloy	SKU.
70mm MI x 19mm (¾") MBSP	SKU:059400
70mm MI x 19mm (¾") MBSP with Brass Tap	SKU:088000
70mm MI x 25mm (1") MBSP	SKU:059500
70mm MI x 38mm (1½") MBSP	SKU:057700
70mm MI x 64mm (2½") MBSP	SKU:056900
70mm MI x 70mm MI	SKU:057300
70mm MI x 75mm (3") MBSP	SKU:057100
70mm MI x 25mm (1") FBSP	SKU:038400
70mm MI x 38mm (1½") FBSP	SKU:059900
70mm MI x 50mm (2") FBSP	SKU:056800
70mm MI x 64mm (2½") FBSP	SKU:057000
70mm MI x 75mm (3") FBSP	SKU:057200
70mm FI x 38mm (1½") MBSP	SKU:056100
70mm FI x 50mm (2") MBSP	SKU:058300
70mm FI x 64mm (2½") MBSP	SKU:056400
70mm FI x 75mm (3") MBSP	SKU:056600
70mm FI x 25mm (1") FBSP	SKU:038300
70mm FI x 38mm (1½") FBSP	SKU:056200
70mm FI x 50mm (2") FBSP	SKU:056300
70mm FI x 64mm (2½") FBSP	SKU:056500
70mm FI x 75mm (3") FBSP	SKU:056700
70mm FI x 64mm (2½") MBSP Double Pull	SKU:037900
70mm FI x 64mm (2½") MBSPT Double Pull	SKU:061700
70mm FI x 64mm (2½") FBSP Double Pull	SKU:60078
70mm FI x 70mm FI Double Pull	SKU:057400

Also available in Gun Metal.

For forestry adaptors see page 24. Wide range of standard thread sizes available in MBSP, FBSP, MI and FI options or can be customised to suit your application.

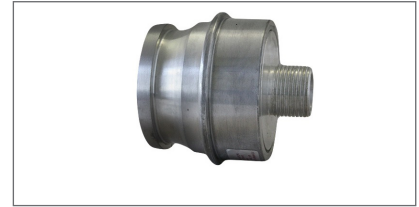

70mm MI x 25mm (1") MBSP (SKU:059500)



70mm MI x 19mm (¾") MBSP with Brass Tap (SKU:088000)



70mm MI x 64mm (2½") FBSP (SKU:057000)



70mm FI x 50mm (2") MBSP (SKU:058300)



70mm FI x 64mm (2½") MBSP Double Pull (SKU:037900)

Single Lever Adaptors



Single lever adaptors have been manufactured to ensure connections to hose are to the highest safety recommendations. Precision machined in either fully heat treated polished aluminium alloy, or gun metal with bright chrome plated finish. SNZ PAS 4505 / BS336 standard.

Models

70mm FI x 64mm (2½") FBSP

- Light Alloy (SKU:065800)
- Gun Metal (SKU:065900)

Options

Can also be manufactured in 2½" (64mm) FBI x customer required thread.

Identification of BSP Threads

Nominal Bore		Number of threads per inch	Major Diameter (OD of Male)		Minor Diameter (ID of Female)	
inch	mm		inch	mm	inch	mm
1/16"		28	0.304	7.723	0.2583	6.561
1/8"		28	0.383	9.728	0.3372	8.566
1/4"		19	0.518	13.157	0.4506	11.445
3/8"		19	0.656	16.662	0.5886	14.950
1/2"		14	0.825	20.955	0.7336	18.631
5/8"		14	0.902	22.911	0.8106	20.587
3/4"		14	1.041	26.441	0.9496	24.117
7/8"		14	1.189	30.201	1.0976	27.877
<hr/>						
1"	25mm	11	1.309	33.249	1.1926	30.291
1 1/8"		11		37.897		34.939
1 1/4"		11	1.650	41.910	1.5336	38.952
<hr/>						
1 1/2"	38mm	11	1.882	47.803	1.7656	44.845
<hr/>						
1 3/4"	45mm	11		53.746	1.9996	50.788
<hr/>						
2"	50mm	11	2.347	59.614	2.2306	56.656
2 1/4"		11		65.710	2.4706	62.752
<hr/>						
2 1/2"	64mm	11	2.960	75.184	2.8436	72.226
2 3/4"		11		81.534	3.0936	78.576
<hr/>						
3"	75mm	11	3.460	87.884	3.3436	84.926
3 1/2"		11		100.330		97.372
<hr/>						
4"	100mm	11	4.450	113.030	4.3336	110.072
<hr/>						
4 1/2"	115mm	11		125.730		122.772
5"		11	5.450	138.430		135.472
5 1/2"		11		151.130		148.172
<hr/>						
6"	150mm	11	6.450	163.830		160.372



SKU: 065800



SKU: 065900

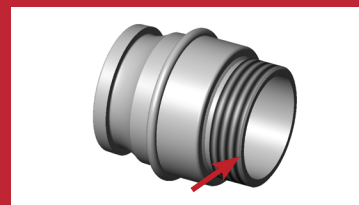

Male Thread
(Measure outside diameter.)

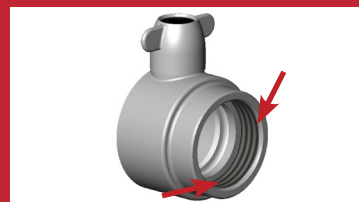

Female Thread
(Measure inside diameter)

ADAPTORS / FITTINGS / FIRE HARDWARE



Round Thread Adaptors

These fittings are ideal for accessing water from water tanks direct to fire trucks. Precision machined in heat treated light aluminium alloy. SNZ PAS 4509:2003 standard.

Models

- 100mm FRT x 100mm FBSP Swivel (SKU:059000)**
- 100mm FRT x 100mm MBSP Swivel (SKU:058900)**
- 100mm FRT x 75mm MRT Swivel (SKU:059100)**
- 100mm FRT x 70mm MI Fixed (SKU:057600)**
- 140mm FRT x 100mm MRT Fixed (SKU:058500)**
- 100mm FRT x 75mm Storz Fixed (SKU:60102)**
- 100mm FRT x 100mm Storz Fixed (SKU:60100)**
- 100mm MRT x 100mm Storz Fixed (SKU:60099)**
- Firefighting Connection irrigation pipe c/w single lever adaptor (SKU: 090500)**

Options

Other thread combinations available upon request.



100mm FRT x 100mm FBSP Swivel (SKU:059000)



100mm FRT x 100mm MBSP Swivel (SKU:058900)



100mm FRT x 75mm MRT Swivel (SKU:059100)



100mm FRT x 70mm MI Fixed (SKU:057600)

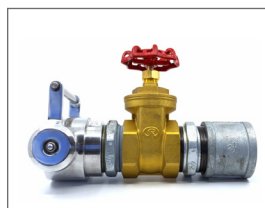

Firefighting irrigation pipe SKU: 090500



140mm FRT x 100mm MRT Fixed (SKU:058500)



100mm MRT x 100mm Storz Fixed (SKU:60099)

Fire Fighting Tank Adaptor Kit

These adaptor one stop kits are ideal for accessing water from water tanks direct to fire trucks. 2 standard tank kits available, all with 100mm FRT x 100mm FBSP swivel head adaptor and supporting bracket. SNZ PAS 4509:2003.

Models

Butterfly Valve (SKU:60021)

Options

Fitting comes standard with 100mm FBSP but can be supplied with 100mm MBSP or 100mm table D or E flange.



Butterfly Valve (SKU:60021)



70mm MI x 25mm (1") MBSP (SKU:60023)

Blank Caps

High quality Blank Caps in a wide range of configurations for pumps, standpipes, hydrant inlet and outlets, and fire appliances. Precision machined in heat treated light aluminium alloy or gun metal to SNZ PAS 4505 / BS336 standard with a chrome plated or polished finish. Some models come complete with pressure release and connecting wire/chain.

Models

- 70mm FI - Light Alloy with Pressure Release (SKU:055400)
 - 70mm MI - Light Alloy with Pressure Release (SKU:055600)
 - GM with Pressure Release (SKU:055900)
 - 70mm MI - Light Alloy (SKU:055700)
 - 75mm FRT - Light Alloy (SKU:055000)
 - 100mm FRT - Light Alloy (SKU:055100)
 - 100mm MRT - Light Alloy (SKU:055300)
 - 140mm FRT - Light Alloy (SKU:055200)
- For Forestry Blank Caps see page 24.

Breechings

Manufactured in heat treated light aluminium alloy or gun metal. 70mm Instantaneous inlets and outlets to SNZ PAS 4505 standard.

Models

- Firemaster Controlled Dividing Breeching 70mm MI x 70mm FI (x2) (SKU:053800)
 - Firemaster Uncontrolled Dividing Breeching 70mm MI x 70mm FI (x2) (SKU:053700)
 - Firemaster Uncontrolled Collecting Breeching 70mm FI x 70mm MI (x2) (SKU:053900)
- For Forestry Breechings see page 25.

Options

Storz or screw threads to inlets and outlets available to customer requirements.



70mm FI - Light Alloy with Pressure Release (SKU:055400)



70mm MI - Light Alloy LA with Pressure Release (SKU:055600)



70mm MI - Light Alloy GM with Pressure Release (SKU:055900)



70mm MI - Light Alloy (SKU:055700)

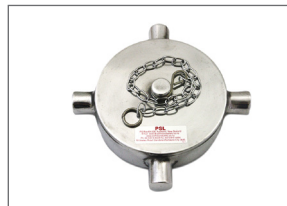

100mm FRT - Light Alloy (SKU:055100)



100mm MRT - Light Alloy (SKU:055300)



Firemaster Controlled Dividing Breeching 70mm MI x 70mm FI (x2) (SKU:053800) (SKU:058500)



Firemaster Uncontrolled Dividing Breeching 70mm MI x 70mm FI (x2) (SKU:053700)



Firemaster Uncontrolled Collecting Breeching 70mm FI x 70mm MI (x2) (SKU:053900)

ADAPTORS / FITTINGS / FIRE HARDWARE



Flow Meters

A compact ready to use, hydrant flow/static metering system designed to fit directly onto a hydrant standpipe, from which the flow discharges horizontally. Packed in a Nanuk protective case with foam inner for safe transportation and storage..

Models

Giddens Hydrant Flow Meter (SKU:063300)

3.3 - 54 l/s, comes in a Nanuk 925 Case

Firemaster Electronic Flow Meter (SKU:035600)

1.5 - 30.1 l/s, comes in a Nanuk 985 Case

TSI FlowMaster 250DL (SKU:146000) 0.5 - 50 l/s

Inlet Pressure Gauge 70mm (SKU:60030)



Giddens Hydrant Flow Meter (SKU:063300)

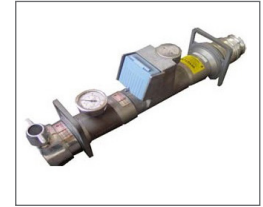

Firemaster Electronic Flow Meter (SKU:035600)



TSI FlowMaster 250DL (SKU:146000)

General Fire Fittings

Quality fire fittings manufactured from light aluminium alloy, gun metal or stainless steel. Customised sizes and options available upon request.

Models

Firemaster Flanges - All sizes and combinations can be made to order.

Firemaster Short Branch

70mm MI x 45mm (1¾") MBSP

- Light Alloy (SKU:068100)

- Gun Metal (SKU:068500)

70mm MI x 38mm (1½") MBSP

- Light Alloy (SKU:NPN100559)

- Dairy Cock - 38mm (1½") MBSP inlet (SKU:011300)

- Treacle Cock (SKU:011200) - Gun metal, 50mm (2")

MBSP inlet.

Tank Filler Cap and Strainer (SKU:064600)

Stainless steel mesh spring and alloy body



Flanges



SKU:068100

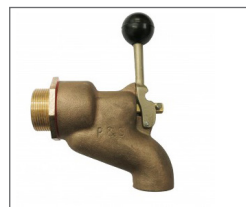

Dairy Cock (SKU:011300)



Treacle Cock (SKU:011200)



Tank Filler Cap and Strainer (SKU:064600)

Inlet Manifolds & Collecting Heads



Precision machined in heat treated light aluminium alloy to SNZ PAS 4505 / BS336 standard. Spring loaded non return valves feature stainless steel components to prevent corrosion. Clapper type valves also available.

Models (in-line):

Two-way 70mm inlets x 75mm FRT

Spring Type valve (SKU:064000)

Two-way 70mm inlets x 100mm FRT

Spring Type valve (SKU:064100)

Clapper Type valve (SKU:064200)

Two-way 70mm inlets x 140mm FRT

Spring Type valve (SKU:035700)

Clapper Type valve (SKU:063900)

Two-way 64mm (2½") BI inlets x 100mm FRT

Spring Type valve (SKU:035700)

Three-way 64mm (2½") BI inlets x 100mm FRT

Spring Type valve (SKU:152600)

Three-way 64mm (2½") BI inlets x 140mm FRT

Spring Type valve (SKU:110400)

Models (Radial):

Three-way 70mm inlets x 140mm FRT

Spring Type valve (SKU:035800)

Three-way 64mm (2½") BI inlets x 140mm FRT

Spring Type valve c/w Blank Caps (SKU:063100)

Four-way 64mm (2½") BI inlets x 140mm FRT

Spring Type valve (SKU:111600)

Options

All combinations available in both in-line or radial configurations, plus we can design and build fully to your requirements.

Some models are not a stock item and are manufactured to order. MOQ's may apply.



Two-way 70mm inlets x 100mm FRT Spring Type valve (SKU:064100)



Two-way 70mm inlets x 140mm FRT Clapper Type valve (SKU:063900)

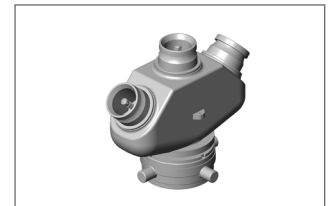

Three-way 64mm (2½") BI inlets x 100mm FRT Spring Type valve (SKU:152600)



Three-way 70mm inlets x 140mm FRT Spring Type valve (SKU:035800) (SKU:058500)

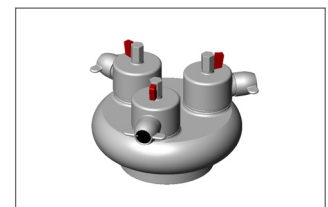

Three-way 64mm (2½") BI inlets x 140mm FRT Spring Type valve c/w Blank Caps (SKU:063100)



Four-way 64mm (2½") BI inlets x 140mm FRT Spring Type valve (SKU:111600)

Riser Main - Brigade Inlet Breechings

PSL's Brigade Inlet Breechings are manufactured from LG2 gun metal to SNZ PAS 4505 standard. All fitted with standard 70mm (2¾") male instantaneous adaptors, and come complete with individual clapper valves.

Models

- 100mm MBSP x 1 WAY** (SKU:066000)
- 100mm TABLE D x 1 WAY** (SKU:066100)
- 100mm MBSP x 2 WAY** (SKU:066400)
- 100mm TABLE D x 2 WAY** (SKU:066500)
- 150mm TABLE D x 4 WAY** (SKU:066600)

Tank Filler Cap and Strainer (SKU:064600)
Stainless steel mesh spring and alloy body

Optional Extra

Test Device - Brigade Inlet Breeching (SKU:072000)

Options

2½" (64mm) BI are available upon application. Other sizes and combinations to your requirements.

Some models are not a stock item and are manufactured to order. MOQ's may apply.

Ladders, Gantries & Shutters

10.5m AS ladders are made to exact standards and safety requirements by internationally known company.

Models

- AS Fire Appliance Ladders
- AS 464
- All sizes and configurations made to order.



100mm MBSP x 2 WAY
(SKU:066400)



150mm TABLE D x 4 WAY
(SKU:066600)



Test Device - Brigade Inlet
Breeching (SKU:072000)



As Fire Appliance Ladders



Ladder Gantry

Rise Main -Landing Valves



PSL's landing valves conform to SNZ PAS 4505 standard and are approved by the Insurance Council of New Zealand. All gun metal (LG2) construction, they come equipped with a blank cap and pressure release.

Models:

- 64mm MBSP** (SKU:066200)
- 64mm FLANGED - TABLE D** (SKU:066300)
- 64mm FLANGED - FF ANSI 150** (SKU:066900)
- 75mm FLANGED - FF ANSI 150** (SKU:066700)
- 75mm FLANGED - RF ASA 150** (SKU:066800)

Optional Extra:

Brigade Inlet Check Valve Flanged 70mm MI (SKU:066502) **Air Release Valve** (SKU:7214)

Options:

Other sizes and combinations to your requirements. Available with single lever or double pull adaptors.



64mm MBSP (SKU:066200)



64mm FLANGED - TABLE D (SKU:066300)



(SKU:0663-IND)



(SKU:066502) - PSL SPEC (SKU:NPN122719) - NON PSL SPEC



BEFORE REFURBISH



AFTER REFURBISH

Riser Main - Industrial Landing Valves

PSL offer a range of industrial quality landing valves as an alternative to our Premier range. Body in brass, aluminium hand wheel and polished gun metal blank cap and pressure release.

Models:

- 64mm MBSP** (SKU:0662-IND)
- 64mm Table D Flange** (SKU:0663-IND)

Options

Other sizes and combinations to your requirements.



64mm MBSP (SKU:0662-IND)



64mm Table D Flange (SKU:0663-IND)

FIRE HARDWARE / EXTINGUISHERS



Standpipes

Be it for accessing water from the local authority main for a fire or using one of our specially manufactured metered standpipes PSL standpipes are manufactured in-house, to assure value and reliability.

Models

Double Controlled Standpipe

with Double Lug Adaptors (SKU:034000)

with 70mm FI Adaptors (SKU:054100)

Uncontrolled Standpipe

Single Head (SKU:054300)

Double Head (SKU:054200)

Mechanical Metered Standpipe (SKU:034200)

Standpipe with Backflow Prevention

(SKU:035400)

Contractor Standpipe

70mm FI (SKU:054000)

64mm (2½") MBSP (SKU:054400)

Optional Extra:

LA Hydrant Key and Bar (SKU:054900-R)

LA Hydrant Key and Bar Industrial

(SKU:0549-IND)

Contractor Hydrant Key Fixed (SKU:054800)

Quick Release Clamp (SKU:064400)

Standpipe Clamp (SKU:119400)

Light Alloy Standpipe Plinth (SKU:064300)

Contractor Standpipe Base (SKU:054001)

Light Alloy 64mm (2½") FBSP



Double Controlled Standpipe with Double Lug Adaptors (SKU:034000)



Double Controlled Standpipe with 70mm FI Adaptors (SKU:054100)



Uncontrolled Standpipe Single Head (SKU:054300)

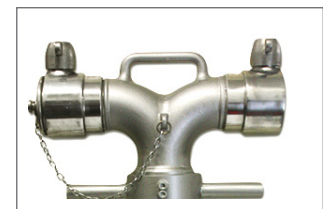

Uncontrolled Standpipe Double Head (SKU:054200)



Mechanical Metered Standpipe (SKU:034200)



Standpipe with Backflow Prevention (SKU:035400)



Mechanical Metered Standpipe (SKU:034200)

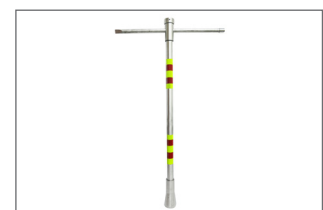

Hydrant Key & Bar LA (SKU:054900-R)



Quick Release Clamp (SKU:064400)



Contractor Standpipe Base (SKU:054001)



LA Hydrant Key and Bar Industrial (SKU:0549-IND)



Contractor Hydrant Key Fixed (SKU:054800)

Steel cylinder powder coated red, brass chrome plated valve assembly, stainless steel gauge and safety pin seal. Powder content is Mono-Ammonium Phosphate ABE type (85% MAP content). AS/NZS 1841:5 standard (0.3kg EN3 standard only.)

Models:

Flamefighter 0.3kg ABE (SKU:8409) comes with plastic clip-on bracket. Rating: N/A

Flamefighter II 1kg ABE (SKU:8425) comes with vehicle bracket. Rating: 1A:20B:E

Flamefighter II 1.5kg ABE (SKU:8411) comes with vehicle bracket. Rating: 2A:20B:E

Flamefighter II 2kg ABE (SKU:8412) comes with vehicle bracket. Rating: 3A:30B:E

Flamefighter II 2.5kg ABE (SKU:8413) comes with vehicle bracket. Rating: 3A:40B:E

Flamefighter II 4.5kg ABE (SKU:8414) comes with wall bracket. Rating: 4A:60B:E

Flamefighter II 6kg ABE (SKU:8415) comes with wall bracket. Rating: 4A:80B:E

Flamefighter II 9kg ABE (SKU:8416) comes with wall bracket. Rating: 6A:80B:E

Optional Extra:

Heavy Duty Brackets:

2.5kg (SKU:8430-4),

4.5kg (SKU:8440-1),

9kg (SKU:8460-1)

Double Strap Brackets:

1kg (SKU:8425-7),

1.5kg (SKU:8411-3),

2kg (SKU:8412-3)

Extinguisher Cabinets:

2kg - 2.5kg (SKU:7429-8),

4.5kg (SKU:8413-4),

6kg (SKU:8413-4),

9kg (SKU:8414-4)



SKU: 8409



SKU: 8425



SKU 8411



SKU 8412



SKU 8413



SKU 8414



SKU 8415



SKU 8416



SKU 8460-1



SKU 8425-7



SKU 7429-8



SKU 8413-4



SKU 8409-1

EXTINGUISHERS



Extinguishers - CO2, Water
Foam & Wet Chemical

CO2: Alloy construction. AS/NZS 1841:6 standard.

Water: Stainless steel cylinder powder coated red, brass valve. AS/NZS 1841.2 standard.

Foam: Stainless steel, powder coated red, brass valve. AS/NZS 1841.4 standard.

Wet Chem: Stainless steel cylinder powder coated red. AS/NZS 1841:3 standard.

Models:

Flamefighter 2kg CO2 (SKU:8465) comes with wall bracket
Rating: 2B:E

Flamefighter 3.5kg CO2 (SKU:8466) comes with wall
bracket. Rating: 10B:E

Flamefighter 5kg CO2 (SKU:8467) comes with wall bracket
Rating: 10B:E

Flamefighter 9L Water (SKU:8485) Rating: 3A

Flamefighter 9L Foam (SKU:8490) Rating: 3A:30B

Flamefighter 2L Wet Chem (SKU:8450) comes with wall
bracket. Rating: 4F

Flamefighter 7L Wet Chem (SKU:8455) comes with wall
bracket. Rating: 4F

Optional Extra:

Heavy Duty Brackets:

9L (SKU:8485-1)

Smaller heavy duty brackets available on indent.

Extinguisher Cabinets:

2kg (SKU:8413-4)

3.5kg - 5kg (SKU:8416-4),

2L/9L (SKU:8414-4)

7L (SKU:8416-4)

Top Loader Cabinet JBFR65 (SKU: 8721)

Top Loader Cabinet JBFR75 (SKU: 8722)



SKU: 8465



SKU: 8466



SKU 8467



SKU 8485



SKU 8490



SKU 8450



SKU 8455



SKU 8485-1



SKU 8414-4



SKU 8721



SKU 8722

Manufactured to AS/NZS 1221 standards (NZ4504 also available) from Zintec and has a 4mm perimeter flange. It has a flush door with full length piano hinge and comes complete with a D handle. The cabinet is polyester powder coated for quality finish and durability.

Models:

Cabinet

13mm x 25m (SKU:2672-FC1325)

13mm x 30m (SKU:2672-FC1330)

19mm x 25m (SKU:2673-FC1925)

Jumbo Hose Reel Cabinet (70cm L x 100cm H x 32cm W)
(SKU:1675-FCS)

Hose Reel Cabinet Shroud (SKU:0673-SDF)

Options:

Bare hose cabinets also available. Also available in Stainless Steel.

Hose Reels

PSL offer a wide range of fire hose reels in various sizes and lengths. They come complete with back pipe, stop cock, nozzle and hose guide ready for installation. All reels comply to AS/NZS:1221.

Models:

Flamefighter Jumbo Hose Reel

Swivel, 19mm x 36m (SKU:1675-1936S)

Fixed, 19mm x 36m (SKU:1675-1936F)

Hose Reel

13mm x 25m (SKU:0672-1325)

13mm x 30m (SKU:0672-1330)

19mm x 25m (SKU:0673-1925)

19mm x 36m - Jumbo (SKU:0675-1936)

25mm x 30m - Jumbo (SKU:0675-2530)

Optional Extra:

PVC Hose Reel Cover

Regular (SKU:0673-C)

Jumbo (SKU:0675-C)

Note: Bare hose reels also available. Some models also available in Stainless steel. Hose reel nozzles, see page 29



SKU: 1675-FCS



SKU: 2672-FC1330



SKU:1675-FCS)



SKU: 0673-SDF



SKU: 1675-1936S



SKU: 1675-1936F



SKU: 0674-1325



SKU: 0673-1925



SKU: 0673-C

SITEPOINT / BLAZONS / FIRE BLANKETS



Sitepoints

SitePoint is a multi-purpose mobile unit offering 100 litre storage capacity and display panel of 1060 x 580 mm. Highly customisable with Jonesco and third-party products to provide information and access to PPE, first aid, eye wash, fire extinguishers, spill control, lock-outs, etc.

Models:

Jonesco Sitepoint Plastic Toggle Red (SKU: 7526-R)

Jonesco Sitepoint Plastic Toggle Green (SKU: 7526-G)

Jonesco Sitepoint Plastic Toggle Yellow (SKU: 7526-Y)

Indent order only. MOQ's apply.



SKU: 7526-R / G / Y



Fire Extinguishers - Fire Blazons

High-visibility PVC signage.

NZS 4503 standard.

40cm x 20cm.

Models:

ABE Dry Powder Extinguisher (SKU:7823)

AFFF Foam Extinguisher (SKU:7821)

Carbon Dioxide CO2 Extinguisher (SKU:7822)

Fire Blanket (SKU:7827)

Fire Hose Reel (SKU:7826)

Water Fire Extinguisher (SKU:7825)

Wet Chemical Fire Extinguisher (SKU:7824)



SKU 7823



SKU 7821



SKU 7822



SKU 7827



SKU 7826



SKU 7825



SKU 7824

Woven glass fibre material. Packed in their own custom built easily accessed holder. AS/NZS 3504 standard.

Models:

Flamefighter Fire Blanket

1.0m x 1.0m (SKU:7425)

1.2m x 1.8m (SKU:7426)

1.8m x 1.8m (SKU:7427)

Flamefighter Hard Case Fire Blanket

1.0m x 1.0m (SKU:7425-C)

1.2m x 1.8m (SKU:7426-C)

1.8m x 1.8m (SKU:7427-C)



SKU: 7425



SKU: 7426



SKU 7427



SKU 7425-c



SKU 7425-c



SKU 7426-c



SKU 7427-c

Break Glass Key Holders

ABS plastic and crystal styrene window. 110mm x 33mm.

Models:

Flamefighter Break Glass Key Holder (SKU:7438)

Optional Extra

Spare printed window (SKU:7444)



SKU 1775-FC1936SS

FORESTRY



Foam & Foam Equipment

Scotty Backpacks are designed to be a simple, portable reservoir for water concentrate. They provide the wearer with a safe and comfortable way to carry liquids used during fire operations.

Models:

- Scotty Foam Backpack System (SKU:4219)
- Indian Smoke Chaser Pro Backpack - (SKU:4300)
- Indian Smokechaser Vinyl Backpack w/Pistol Grip- (SKU:4302)
- Scotty Bravo (SKU:4082)



SKU: 4219



SKU: 4300



Foam Branchpipes

Delta produce a wide range of foam branchpipes, foam inductors, mobile foam units and other specialised foam application equipment.

Models:

- Delta Low Expansion Foam Branchpipe
- HV225 - 225 litres/minute (SKU:7711)
- self inducting (SKU:7701)
- HV450 - 450 litres/minute (SKU:7712)
- self inducting (SKU:7702)
- HV900 - 900 litres/minute (SKU:7713)
- self inducting (SKU:7703)
- Delta Medium Expansion Foam Branchpipe
- M225 - 225 litres/minute (SKU:7708)
- M450 - 450 litres/minute (SKU:7709)
- M900 - 900 litres/minute (SKU:7710)



SKU 7711



SKU 7827



SKU 7825

PHOS-CHEK®
Foam & Foam Equipment



Phos-Chek's concentrate and long term retardants are a must for effective fire fighting.

Models:

- Phos-Chek 259F Retardant
- Phos-Chek 259Fx Retardant (SKU: 6447)
- Phos-Chek Class A Foam - MOQ's Apply
- Phos-Chek Class B Foam - MOQ's Apply

Class B foam options available on request. Indent only



Foam inductors provide a simple cost effective means of introducing foam concentrates into the water stream. Designed for 1% - 6% concentration pickup.

Models:

- Scotty 4060 Foam Inductor
- 15 GPM - 1% (SKU:4222)
- 30 GPM - 1% (SKU:4208)
- 50 GPM - 1% (SKU:4209)
- 70 GPM - 1% (SKU:4232)
- 95 GPM - 1% (SKU:4244)
- Also available for 0.5% or 3% education rates
- Delta Variable Inductors
- Z225 - 225 litres/minute (SKU:7704)
- Z450 - 450 litres/minute (SKU:7705)
- Z900 - 900 litres/minute (SKU:7706)



The DF130 Mobile Foam Unit is ideal for protecting oil storage and loading terminals, paint and solvent stores, boiler engine rooms and other high risk areas.

Models:

- Delta DF130 Mobile Foam Unit (SKU:7717)



SKU:4208



SKU:7704



SKU:7717

FORESTRY



Foam & Foam Equipment

Made from the latest engineered grade polymers all the nozzles are compatible with NZ hose.

Models:

Akron Quick Attack Foam Tube (SKU:7200-07770001)

Scotty Fog/Straight Stream Nozzle

Low-Flow (55 - 190 GPM) (SKU:4038-30)

High-Flow (190 - 380 GPM) (SKU:4038-70)

Scotty Pistol Grip Nozzle

Low-Flow (55 - 190 GPM) (SKU:4037-30)

High-Flow (190 - 380 GPM) (SKU:4037-70)

Scotty Air Aspirating Foam Nozzle

15 GPM (SKU:4221)

30 GPM (SKU:4205)

50 GPM (SKU:4206)

70 GPM (SKU:4231)

95 GPM (SKU:4246)

Scotty Smooth Bore Nozzle

50 GPM (SKU:4032)

100 GPM (SKU:4032-100)

Scotty D Handle Shut-Off (SKU:4226)

with Pistol Grip (SKU:4211)

Scotty Foam Maker Nozzle (SKU:4224)

Scotty Variable Check Valve

15 GPM (SKU:4227)

30 GPM (SKU:4223)

50 GPM (SKU:4228)

70 GPM (SKU:4229)

95 GPM (SKU:4230)

Scotty Foam Gun (SKU:4267)

Phos-Chek Class A Foam Sticks

Pack of 3 (SKU:4268)

For more Nozzles see page 31.



SKU: 7200-07770001



SKU: 4038-30



SKU: 4037-30



SKU: 4221, 4205, 4206, 4231, 4246



SKU: 4032



SKU: 4211



SKU: 4224



SKU: 4223



SKU: 4267



SKU: 4268

Rural firefighting equipment needs to be reliable, robust and portable. PSL's range of rural fire fighting equipment will meet all your requirements.

Models:

Firemaster Hydroblender (SKU:028000)

Hydroblender & Mounting Frame (SKU:027800)

Hydroblender Mounting Frame (SKU:7603)

Hydroblender Capsule Holder (SKU:P5530)

Firemaster Basket Strainer & Skirt

to suit 50mm hose (SKU:7213)

to suit 75mm hose (SKU:7208)

to suit 100mm hose (SKU:7209)

to suit 140mm hose (SKU:7211)

Firemaster Suction Strainer

75mm (SKU:053000)

100mm (SKU:053100)

140mm (SKU:053300)

Scotty Forestry Water Backpacks

19L (SKU:4220)

22L BRAVO (SKU:4082)

DOC spec Forestry Hose Backpacks

Green for 41mm percolating hose (SKU:7652)

Blue for 41mm non-percolating hose (SKU:7653)

Red for 25mm non-percolating hose (SKU:7654)

Red and Blue backpacks available complete with hose.

Aquadam

2,200 LTR (SKU:8149)

5,000 LTR (SKU:8150)

10,000 LTR (SKU:8151)

15,000 LTR (SKU:8152)

20,000 LTR (SKU:8153)

Flexidam

1,200 LTR (SKU:8092)

2,200 LTR (SKU:8093)

5,000 LTR (SKU:7254)

10,000 LTR (SKU:72-116489)

15,000 LTR (SKU:NPN2317)

18,000 LTR (SKU:t.b.a.)

25,000 LTR (SKU:t.b.a.)

40,000 LTR (SKU:t.b.a.)

Smokechaser Pro (SKU: 4300)



SKU: 027800



SKU: 7603



SKU: 7213



SKU: 053000



SKU: 4220



SKU: 4082



SKU: 7652



SKU: 8149



Flexidam SKU: 7254

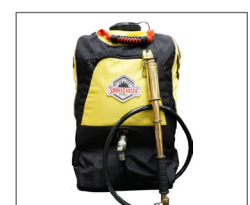

SKU: 4300

PSL can supply a wide range of adaptors specifically suited to forest and rural fire equipment. All alloy fittings are heat treated for strength and durability, with precision CNC machined threads for accuracy. Also feature heavy knurled parts for slip-free tightening and loosening of fittings.

Models:

41mm Female to Female Swivel, ND265

(SKU:026500)

41mm FBSP x 41mm MBSP Thread Protector, ND11 (SKU:026400)

38mm FBSP x 25mm MBSP (SKU:027700)

Wajax Pump 1½" FNPSH x 41mm MBSP (SKU:027300)

Relay Pumping, 50mm Female Camlock

c/w ND265 Coupling (SKU:028100)

Hose Tank Filling Adaptor, ND338 (SKU:025700)

Options:

Other thread combinations available upon request.

Quick Connect Adaptors to suit 25mm and 41/38mm forestry fire fighting hose:

SKU: 7656 - F

SKU: 7656-M



SKU:026500

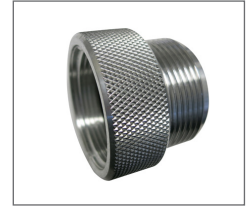

SKU: 026400



SKU: 027700



SKU: 027300



SKU: 028100



SKU: 025700



Forestry Blank Caps

PSL Forestry Blank Caps are precision made from heat treated aluminium and feature knurled edges for easy grip and non-slip operation, and come complete with a stainless steel link chain.

Models:

41mm Male BSP, ND91 (SKU:026000)

41mm Female BSP, ND49 (SKU:026100)

Options:

Other thread combinations available upon request.



SKU: 026000



SKU: 026100

Manufactured from heat treated light aluminium alloy. The Controlled breechings have Marine anodised balls for extended life. 70mm Instantaneous inlets and outlets to SNZ PAS 4505 standard.

Models:

Firemaster Forestry Controlled Dividing Breeching

Inlet: 41mm Male BSP thread
Outlet: 2 x 41mm Male BSP (SKU:027500)

Firemaster Forestry Controlled Dividing Breeching

Inlet: Double Female BSP 41mm swivel
Outlet: 2 x 41mm Male BSP with Thread Protectors (SKU:024000)

Firemaster Forestry Controlled Dividing Breeching

Inlet: 70mm Instantaneous
Outlet: 2 x 41mm Male BSP thread (SKU:027600)

Firemaster Forestry Uncontrolled Dividing Breeching, ND48

Inlet: 70mm Instantaneous
Outlet: 2 x 41mm Male BSP with Blank Caps (SKU:027200)

Models:

Other inlet and outlet combinations available to order.

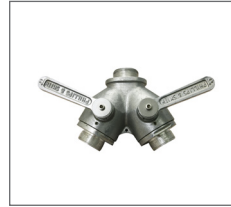

SKU: 027500



SKU: 024000



SKU: 027600



SKU: 027200



25mm QC



SKU: 028300



25mm - SKU:024500
38mm - SKU: 025500

 **Firemaster**

Forestry Couplings

Couplings are manufactured from heat treated light aluminium alloy.

Models:

Firemaster Forestry Coupling

25mm x 41mm head (SKU:025200)
41mm x 41mm head (SKU:028300)
41mm x 41mm head (for perc hose) (SKU:025100)

Light Alloy Quick connect Forestry Couplings to suit 25mm and 41/38mm forestry fire fighting hose:

25mm - SKU: 024500
38mm - SKU: 025500

Mobile 1st Response Pump C/W Hose & Trolley - (SKU: 091000)

Mobile fire-fighting equipment for domestic use. Quick to deploy, easy to manoeuvre & set-up, requiring only one person to operate. The First Response Fire Cart has been designed to utilise available water to deliver high-pressure water at up to 300 litres per minute. The Fire Cart also houses a self-priming (pump requires water to be added in the initial set up), aluminium Honda pump.



SKU: 091000

Hose

PSL's fire hoses can be supplied with our range of Firemaster Instantaneous Couplings including our hydraulically efficient Ferrule Couplings. The Boston Booster hose can be supplied with brass or aluminium barway couplings.

Models:

Fireline Hose

- 25mm x 30m (SKU:8056)
- 38mm x 30m (SKU:8049)
- 41mm x 30m (SKU:8051)
- 45mm x 25m (SKU:8059)
- 64mm x 30m (SKU:8050)
- 70mm x 25m (SKU:8052)
- 90mm x 30m (SKU:8057)

Boston Booster Hose

25mm x 30m (SKU:8031)

Fire Flex Hose

90mm with Banding Fittings (SKU:7057)



With ferrule couplings



With wire tied couplings



SKU: 8031



SKU: 6043 Coupled



SKU:7057

Features low bending radius, good adhesion layer, resistant to heat and weather, excellent abrasion resistance and helix free cuffs.

Models:

Firemaster Rubber Suction Hose

100mm x 2.4m - Coupled (SKU:8010-C) - Hose can be coupled to requirements.

Firemaster Suction Hose

50mm x 2.4m - Coupled (SKU:023900)

Firemaster Clear PVC Suction Hose

100mm x 2.4m - Coupled (Round Thread) (SKU:60095)

100mm x 2.4m - Coupled (Storz) (SKU:60108)

Suction Hose Coupling Wrench (SKU:7212)

Galvanised mild steel

Foldable Storz Spanner (SKU:F464A)

For Suction Strainers see page 23.



SKU: 8010-C



SKU: 023900



SKU: 60108



SKU: 7212



SKU: 60095



SKU: F464A

COUPLINGS



Couplings

Manufactured from heat treated light aluminium alloy.
Some couplings are also available in gun metal.

Models:

Firemaster Internal Ferrule Instantaneous Coupling

70mm x 45mm tail (SKU:102000)

70mm x 70mm tail (SKU:102100)

Firemaster Wire Tied Instantaneous Coupling

70mm x 38mm tail (SKU:037300)

70mm x 45mm tail (SKU:050400)

70mm x 50mm tail (SKU:037400)

70mm x 64mm tail (SKU:037500)

70mm x 70mm tail (SKU:050600)

70mm x 75mm tail (SKU:037600)

70mm x 90mm tail (SKU:051300)

Some sizes also available in 64mm (2½")

Firemaster Suction Coupling

75mm x 75mm (SKU:052700)

100mm x 100mm (SKU:052800)

Hose Accessories

PSL offer a wide variety of hose accessories, repair and damage prevention equipment.

Models:

Firemaster Forestry Hose Backpack

See page 23

Firemaster Hose Washing Machine

c/w 70mm MI (SKU:8070)

Stenor Hose Repair (SKU:3211)

Hose Clamp (SKU:3217)

Patches (SKU:3218)

Hose Preparation Kit (SKU:3219)

Red Head Brute Ferrule X-Pander (SKU:7680)

Red Head Brute Model Z Bench Hydraulic Expander (SKU: 7682)

Firemaster Internal Ferrule Coupling Kit

45mm - c/w Small Ferrule Spacers (SKU:102300)

70mm - c/w Large Ferrule Spacers (SKU:102200)

45 & 70mm, Spacers, Nanuk 925 case (SKU:102400)

Firemaster Hose Ramp (SKU:063700)

Light alloy, suit hose up to 70mm



SKU:102000

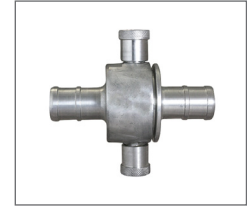

SKU: 050400



SKU: 45mm ferruled vs 45mm wire tied



SKU: 052700



SKU: 7652



SKU: 8070



SKU: 3211



SKU: 7680



SKU: 102400



SKU: 063700

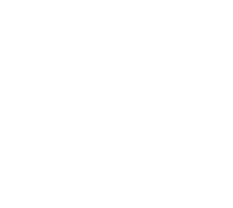

SKU: 7682

Manufactured to international standards these monitors are made to perform.

Models:

- Akron 3" Apollo Single Waterway Monitor
- Akron Apollo Single Inlet Portable Monitor
- Akron GP Manual Monitor
- Akron Omega XP Monitor
- Akron Mercury Quick Attack LE Monitor -
- Akron StreamMaster II Electric Monitor
- Firemaster Deck Monitor -
- Made to customers requirements.



SKU: 3" Apollo



SKU: Apollo



SKU: GP



Akron Mercury Quick Attack LE Monitor



Omega XP



Stream Master



Hose Reel Nozzles

Reliable and easy to fit PSL hose reel nozzles are manufactured to meet the demands of the user.

Models:

Flamefighter Hose Reel Nozzles

Brass Jet/Close Nozzle

- 13mm (SKU:0672-31-GM)
- 19mm (SKU:0673-31-GM)

Plastic Spray Jet Nozzle

- 13mm (SKU:0672-30)
- 19mm (SKU:0673-31)

Brass Twist Nozzle

- 13mm (SKU:NPN120699)
- 19mm (SKU:NPN120709)



SKU: 0672-31-GM



SKU: NPN120699



SKU: 0672-30

NOZZLES



Nozzles

Manufactured from the highest quality propolymer or aluminium materials all our nozzles are made to perform when required.

Models:

Akron Assault Nozzle (SKU:7200-50Y)

Akron Provenger Nozzle (SKU:72-16160010)

Akron Turbojet Nozzle (SKU:7200-51B)

Scotty Pistol Grip Nozzle

Low-Flow (55 - 190 GPM) (SKU:4037-30)

High-Flow (190 - 380 GPM) (SKU:4037-70)

Scotty Fog/Straight Stream Nozzle

Low-Flow (55 - 190 GPM) (SKU:4038-30)

High-Flow (190 - 380 GPM) (SKU:4038-70)

Scotty Air Aspirating Foam Nozzle

15 GPM (SKU:4221)

30 GPM (SKU:4205)

50 GPM (SKU:4206)

70 GPM (SKU:4231)

95 GPM (SKU:4036)

Scotty D Handle Shut-Off (SKU:4226)

with Pistol Grip (SKU:4211)

Firemaster Forestry Nozzle (SKU:7657)

Firemaster Fyrex Jet/Spray Nozzle 38mm FBSP

Light Alloy (TA25) (SKU:1257-IND)

Gun Metal (TB25) (SKU:1264-IND) 45mm FBSP

Light Alloy (FA25) (SKU:0687-IND)

Gun Metal (FB25) (SKU:0689-IND) 64mm FBSP

Light Alloy (FA35) (SKU:068000)

Gun Metal (FB35) (SKU:128000) 64mm FNH

Gun Metal (TB35) (SKU:068800)

Firemaster Straight Flow Nozzle

12mm x 45mm FBSP (SKU:069300)

16mm x 45mm FBSP (SKU:069400)

20mm x 45mm FBSP (SKU:069500)

22mm x 45mm FBSP (SKU:069600)

25mm x 45mm FBSP (SKU:069700)

28mm x 45mm FBSP (SKU:069800)

32mm x 45mm FBSP (SKU:069900)

Firemaster Short Branches (see Page 10)



SKU: 7200-50Y



SKU: 72-16160010



SKU: 7200-51B



SKU: 4037-30



SKU: 4221, 4205, 4206, 4231, 4036



SKU: 4226



SKU: 4211



SKU: 7657



SKU: 068000



SKU: 069300



SKU: 4038-30



FLAMEfighter

Personal Protection

PSL
FIRE & SAFETY
TRUSTED SINCE 1913

Bristol Uniforms is a global brand defined by a dedication to innovation, design and the manufacture of high performance emergency services personal protective garments.

Models:

MSA Bristol Ergotech Uniform

Coat / Trousers

MSA Bristol USAR Uniform

Coat / Trousers

MSA Bristol XFlex Uniform

Coat / Trousers

MSA Bristol X4

Coat / Trousers

Bristol Layerflex Uniform

Coat / Trousers

Level 2 Firefighter Gloves (SKU:9838)

Majestic Flash Hood PAC II PBI (SKU:9510)

Majestic Flash Hood PAC II P84 SVZ (SKU:9511)

Bristol Flashhood 6 (SKU: 6691-M / L)

Bristol Flashhood 7 (SKU: 6692-M / L)

Made to customers requirements.



Bristol Ergotech



Bristol Xflex



USAR



Layer Flex

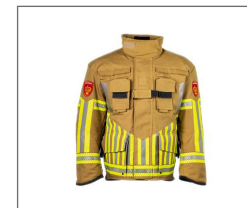

X4



SKU: 9435



SKU: 9838



Bristol Flashhood 6
SKU: 6691-M / L



Bristol Flashhood 7
SKU: 6692-M / L



SKU: 9510



SKU: 9511

PROTECTIVE CASES



Nanuk cases are designed to protect the most sensitive equipment in the harshest environments. Every detail of Nanuk has been refined and perfected to offer the utmost in protection and performance. Available in up to 10 colours.

Models: (Dimensions below are exterior)

Small

Nanuk 903 Case - (L231mm x W173mm x H97mm)

Nanuk 904 Case - (L259mm x W201mm x H114mm)

Nanuk 905 Case - (L239mm x W188mm x H140mm)

Nanuk 908 Case - (L318mm x W249mm x H203mm)

Nanuk 909 Case - (321 mm x 229 mm x 111 mm)

Medium

Nanuk 910 Case - (L363mm x W282mm x H120mm)

Nanuk 915 Case - (L401mm x W307mm x H173mm)

Nanuk 918 Case - (L429mm x W328mm x H236mm)

Nanuk 920 Case - (L424mm x W340mm x H173mm)

Nanuk 923 Case - (L472mm x W366mm x H161mm)

Nanuk 923 Laptop Case - (472mm x 366mm x 161mm)

Nanuk 925 Case - (L475mm x W376mm x H178mm)

Large

Nanuk 930 Case - (L503mm x W406mm x H193mm)

Nanuk 933 Case - (L505mm x W409mm x H257mm)

Nanuk 938 Case - (L 605mm x W394mm x H336mm)

Nanuk 940 Case - (L557mm x W429mm x H216mm)

Nanuk 945 Case - (L638mm x W505mm x H224mm)



Nanuk 903



Nanuk 904



Nanuk 905



Nanuk 910



Nanuk 920



Nanuk 923 Laptop



Nanuk 930



Nanuk 933



Nanuk 940



Nanuk 945

Wheeled

- Nanuk 935 Case - (L559 mm x W356 mm x H229 mm)
- Nanuk 938 Case - (L605 mm x W394 mm x H336 mm)
- Nanuk 950 Case - (L579mm x W465mm x H297mm)
- Nanuk 955 Case - (L650 mm x W508 mm x H300 mm)
- Nanuk 960 Case - (L645mm x W508mm x H368mm)
- Nanuk 963 Case - (L826mm x W533mm x H312mm)
- Nanuk 965 Case - (L826mm x W536mm x H406mm)
- Nanuk 968 Case - (L610mm x W627mm x H345 mm)

Long

- Nanuk 985 Case - (1010 mm x 440 mm x 168 mm)
- Nanuk 990 Case - (L1196mm x W440mm x H168mm)

Media

- Nanuk 905 DJI™ Spark Hard Case
- Nanuk 910 DJI™ Mavic Air Hard Case
- Nanuk 915 DJI™ Spark Fly More Hard Case
- Nanuk 915 DJI™ Mavic Air Fly More Hard Case
- Nanuk 920 Hard Case For DJI™ Mavic 2 Pro | Zoom
- Nanuk 923 DJI™ Ronin-S Hard Case
- Nanuk 940 DJI™ Ronin-m Hard Case



Nanuk 935



Nanuk 938



Nanuk 950



Nanuk 960



Nanuk 985



Nanuk 990



Nanuk 905 DJI Spark



Nanuk 920 DJI Mavic 2 Pro Zoom

RESCUE & SAFETY EQUIPMENT



Pumps

PSL has sourced the best fire pumps the world can offer. From the largest pump to the smallest pump they are made of quality materials and offer years of trouble free operation.

Models:

- Firemaster 18 Twin Delivery** (SKU:5005-18T-70)
- Firemaster 23 RV Portable Pump** (SKU:5005-23-70RV)
- Firemaster 1200 EFI-RVP-OC**
- Firemaster D400 Portable Pump** (SKU:5005-D400-70)
- Firemaster D600 Portable Pump** (SKU:5005-D600-70)
- Wajax Type Hand Primer** (SKU:028900)
- Water Dragon Ejector Pump** (SKU:035200)
- Type A Ejector Pump** (SKU:063500)
- Type B Ejector Pump** (SKU:063400)



SKU: 5005-23-70RV



SKU:
1200 EFI-RVP-OC

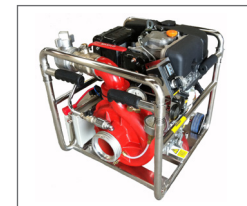

SKU: 5005-D400-70



SKU: 5005-D600-70



SKU: 028900



SKU: 035200



SKU: 063500

Mobile 1st Response Pump C/W Hose & Trolley - (SKU: 091000)



SKU: 091000



5005-23-70TANK



SKU: 063400

Rescue Equipment

Hazard warning identification is an important part of any night operations. PSL range of hazard warning equipment are a safety necessity for all emergency workers.

Models:

Firemaster LED Flashing Wand (SKU:7360)

Red/Green

Lightmaster LED Safety Wand

Red (SKU:6950)

Green (SKU:6951)

Lightmaster Responder Light

Red (SKU:7355-R)

Lightmaster Rechargeable Responder Light Kit

Red (SKU:7354)

Le Maitre GForce 1 Smoke Machine (SKU:7149)

Le Maitre Smoke Fluid (SKU:7100-1)

5 litres

Optional Extras:

Wand Rubberstand (SKU:6952)

Safety Flashing Beacon Rechargeable C/W Magnet

- Amber - SKU: 6930-A
- Red - SKU: 6930-R
- Rubber Base Accessory - SKU: 6931



SKU: 7360



SKU: 6950



SKU: 6951



SKU: 7355-R



SKU: 7354



SKU: 7149



SKU: 6930-A
6930-R



SKU: 6931

RESCUE TOOLS



The right tool to ensure professionals can perform their tasks is essential. PSL has a wide range of rescue and safety equipment.

Models

ResQm8 Rescue Knife (SKU:6750)

Lifehammer Evolution (SKU:7475)

Hooligan Tool

cutting claw 75cm (30") (SKU:7940) (Indent Only)

cutting claw 90cm (36") (SKU:7941) (Indent Only)

standard claw 75cm (30") (SKU:7939) (Indent Only)

standard claw 90cm (36") (SKU:72-118389)

Super Rambar (SKU:7942) (Indent Only)

McLeod Tool (SKU:7644)

Pulaski Tool (SKU:7645)

Firefighter Axe (SKU:7632)

Salvage Sheet (SKU:72-114899) - 3.6m x 3.6m



SKU: 6750



SKU: 7475



SKU: 7644



SKU: 7645



SKU: 7632



SKU: 7938



SKU: 7645



SKU: 72-114899

SIRENS & ALARMS

 **FLAMEfighter**

PSL
FIRE & SAFETY
TRUSTED SINCE 1913

Sirens

Being alerted to impending emergency situations is paramount for quick responses both from the public and emergency personnel. Manufactured in our NZ plant PSL sirens have a reputation for effectiveness, reliability and longevity.

Models

Double Ended Emergency Warning Siren (SKU:063800)

Single Ended Emergency Warning Siren (SKU:047900)



SKU: 063800



SKU: 047900

Smoke Alarms & Heat Alarms **FLAMEfighter**

Fires can happen to anyone at anytime. Early detection by an audible warning device is essential in all domestic and commercial buildings. PSL offers a variety of photoelectric smoke detectors for domestic and small industrial use. These include a 1 year or 10 year battery life detector or our upmarket radio interconnectable.

Models

Flamefighter 1 Yr Photoelectric Smoke Alarm

(SKU: 7462)

Flamefighter 10Yr Photoelectric Micro Smoke Alarm

(SKU: 7478)

Flamefighter 10Yr Photoelectric Mini Smoke Alarm

(SKU: 7464)

Flamefighter 10Yr Photoelectric Interconnectable Smoke Alarm

(SKU: 7477)

Flamefighter Interconnectable Remote (SKU: 7477-R)

Magnetic Fixing Plate (SKU: 7419-M)

Options

Tailored and pre-made safety packages available for home, office, kitchen, computer room, car, truck etc.



SKU: 7462



SKU: 7478



SKU: 7464



SKU: 7477



SKU: 7477-R



SKU: 7419-M

SPECIAL MANUFACTURER

At PSL we understand that it is not always possible to obtain what you want “off the shelf”, and in many instances your fire protection needs are very specialised. This is where our expertise, not just within our own organisation, but also from our extensive world-wide suppliers, really delivers.

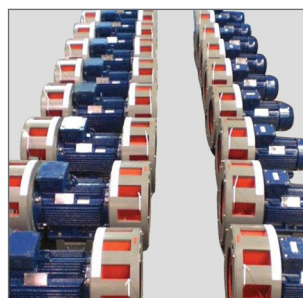
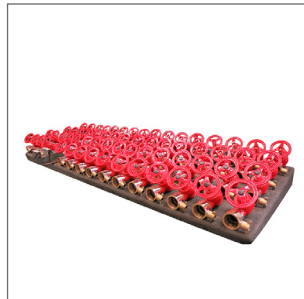
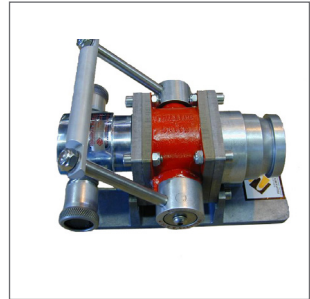

TORCHES



Small Torches

PSL's range of quality torches are capable of providing excellent light source when needed. The diverse range of these torches will meet the requirements of many different users from rescue personnel to everyday users.

Models

Streamlight 2AAA ProPolymer LED Haz-Lo - ATEX
(SKU:66503)

Streamlight 2AA ProPolymer LED ATEX (SKU:67555)

Streamlight 2AA ProPolymer LED Haz-Lo

Yellow (SKU:67101)

Streamlight Polytac 90 LED Right Angle Torch

Black (SKU:88830)

Yellow (SKU:88831)

Streamlight Vantage 180 Right Angle Torch

Orange (SKU:88900)

Black (SKU: 88902)

Streamlight 2AA Dualie (SKU: 67750)

Streamlight 3AA Dualie (SKU: 68782)

Optional Extra:

PSL offer a range of spares, helmet mounts, holsters, chargers etc. Other models available on request.



SKU: 88900



SKU: 66503



SKU: 68782



SKU: 67555



SKU: 67750



SKU: 67101



SKU: 88831

Medium Torches



Models

Streamlight 3C ProPolymer HAZ-LO (SKU:33820)

Streamlight Knucklehead (SKU:90628)



SKU: 33820

TORCHES



Large Torches & Lanterns

PSL's range of lanterns and large torches will give users the confidence of a professional quality assured light source for all situations.

Models

Streamlight E-Flood LiteBox Power Failure System - Orange (SKU:45809)

Streamlight Fire Vulcan LED (SKU:44453)

Streamlight Waypoint SpotLight LED

Yellow (SKU:44900)

Black (SKU:44902)

Streamlight Waypoint Dualie (SKU: 44955)

Streamlight Vulcan 180 (Orange) (SKU: 44314)

Streamlight Portable Scene Light (SKU: 45674)

Streamlight Portable Scene Light II (SKU: 46004)

Optional Extra:

PSL offer a range of spares, helmet mounts, holsters, chargers etc. Other models available on request.



SKU: 44900



SKU: 45809



SKU: 44902



SKU: 44955



SKU: 44314



SKU: 45674

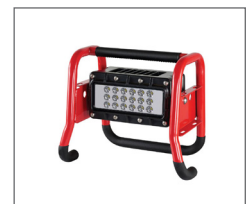

SKU: 46004

Intrinsically Safe Torches



For use in hazardous facilities, intrinsically safe torches will ensure the wearer of safety whilst in these hazardous conditions.

Models

Streamlight 2AAA ProPolymer LED Haz-Lo - ATEX

(SKU:66503)

Streamlight 2AA ProPolymer LED ATEX (SKU:67555)

Streamlight 2AA ProPolymer Xenon (SKU:67201)

Streamlight 3C ProPolymer Haz-Lo (SKU:33820)

Streamlight 3AA Haz-Lo Headlamp LED (SKU:61200)

Streamlight Trident UL Div 2 Headlamp Xenon/LED

(SKU:61050)

Streamlight Vulcan 180 (Orange) (SKU: 44314)

Streamlight BEARTRAP (SKU:61521)



SKU: 66503



SKU: 67555



SKU: 67201



SKU: 33820



SKU: 61200



SKU:61050



SKU: 44314

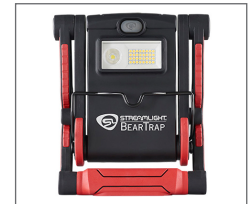

SKU: 61521

HEADLAMPS



PSL's range of headlamps have been specifically designed for hands free lighting yet will offer hours of comfortable wearing.

Models

Streamlight 3AA HAZ-LO LED (SKU:61200)

Streamlight Enduro LED (SKU:61410)

Streamlight ProTac HL (SKU:61304)

Streamlight Trident UL Xenon/LED (SKU:61050)

Models

Streamlight CR123A Batteries (SKU:85175)



SKU: 61200



SKU: 61410



SKU: 61304



SKU: 61052



SKU: 61050



SKU:85175



SKU: 61707



Product
CATALOGUE

CONTACT

10 Akatea Road
Glendene, Auckland 0602
Tel : +64 9 818 8048
Fax : +64 9 818 4484
Web: www.pslfireandsafety.co.nz
Email : sales@pslfireandsafety.co.nz